

### FUNCTION TABLE

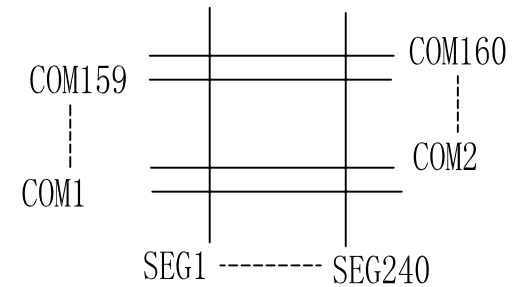

PIN	ASSIGNMENT
1	VLCD
2	VS+
3	VS-
4	VBO-
5	VB1-
6	VB1+
7	VBO+
8	VDD
9	VSS
10	ID1
11	ID0
12	TST4
13	BM1
14	BM0
15	CS0
16	CD
17	WR1
18	WRO
19	RST
20	DO
21	D1
22	D2
23	D3
24	D4
25	D5
26	D6
27	D7
28	D8
29	D9
30	D10
31	D11
32	D12
33	D13
34	D14
35	D15
36	NC

#### NOTES:

1. DISPLAY TYPE: FSTN POSITIVE..
2. POLARIZER MODE: TRANFLECTIVE.
3. OPERATING VOLTAGE. VOP=16V, VDD=3.3V
4. DRIVE METHOD: 1/160 DUTY, 1/12 BIAS.
5. VIEWING DIRECTION: 6 O'CLOCK.
6. IC DRIVER: UC1698U.
7. OPERATING TEMP.: -20°C ~ 70°C.
8. STORAGE TEMP.: -30°C ~ 80°C.
9. LED BACKLIGHT: WHITE LED, If=105mA(TYP.), Vf=3.5V.
10. GENERAL TOLERANCE: ±0.2MM.
11. ROHS COMPLIANT.

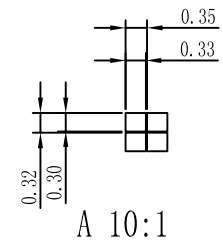

		MULTI-INNO TECHNOLOGY CO.,LTD.	
DRAWN BY:	CAROL	2021.04.23	MODULE P/N:
CHECKED BY:			MI240160F-G
APPROVED BY:			DESCRIPTION:
VERSION NO:	03	UNIT: mm	GRAPHIC MODULE
		SHEET NO.: 1/1	

01	FIRST ISSUE	CAROL	2021.04.23
VER.	REVISED DESCRIPTION	REVISOR	DATE