

(Reference Mechanical Design)

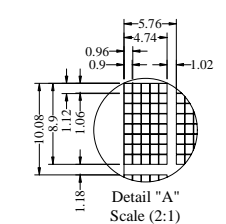

Pin	Symbol
1	N.C
2	VSL
3	VSS
4	REGVDD
5	SHLC
6	SHLS
7	VDD
8	VDDIO
9	BS0
10	BS1
11	BS2
12	GPIO
13	CS#
14	RES#
15	DCE
16	RWR(WR#)
17	ERD#
18	D0
19	D1
20	D2
21	D3
22	D4
23	D5
24	D6
25	D7
26	IREF
27	ROM0
28	ROM1
29	OPR0
30	OPR1
31	VCOMH
32	VCC
33	N.C.

Notes:

1. Color: White
2. Driver IC: US2066
3. Interface: 4-/8-bit 68XX/80XX Parallel, SPI, I2C
4. General Tolerance: ±0.30
5. The total thickness (2.10 Max) is without polarizer protective film & remove tape. The actual assembled total thickness with above materials should be 2.35 Max.

CUSTOMER APVL		DATE	
DRAWN	SCALE	TITLE	
DFTG CHK	UNIT mm	MI1602EO-W	
ENGR CHK	APPROVAL	MODEL	
MULTI-INNO TECHNOLOGY CO.,LTD.		DWG NO	PAGE 1/1