

DETAIL A
(SCALE 50:1)

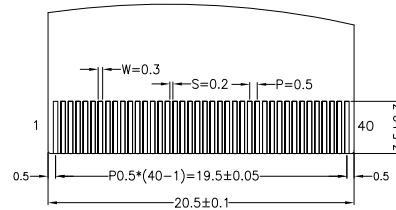

DETAIL B
(SCALE 5:1)

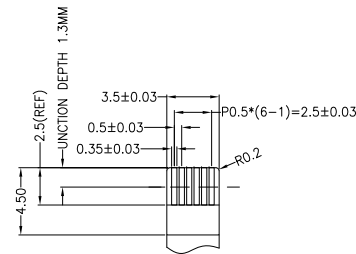

APPLICABLE FPC/FC

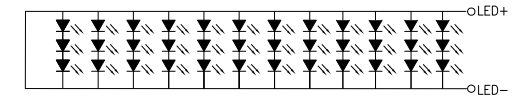

BACKLIGHT CIRCUIT DIAGRAM

NOTES FOR TFT:

1. DISPLAY TYPE: TFT, TRANSMISSIVE, NORMALLY WHITE
2. OPERATING VOLTAGE: VDD=3.3V
3. VIEWING DIRECTION: 12:00 O'CLOCK
4. IC DRIVER: HX8696+HX8282
5. OPERATING TEMP.: -20°C ~ 70°C
6. STORAGE TEMP.: -30°C ~ 80°C
7. LED BACKLIGHT: 36-CHIP WHITE LED, If=240mA, Vf=9.9V
8. SURFACE LUMINANCE: 400cd/m²(TYP.)
9. TOP POLARIZER SURFACE TREATMENT: GLARE
10. GENERAL TOLERANCE: ±0.2MM
11. RoHS COMPLIANT

NOTES FOR CTP:

1. 8.0" PROJECTIVE CAPACITIVE TOUCH PANE
2. OPERATING VOLTAGE: VCC=IOVCC=3.3V
3. COVER GLASS + SENSOR GLASS + FPCC
4. IC DRIVER: GT911
5. RESOLUTION: 1024 x 600 DOTS
6. MULTI FINGERS: UP TO 5
7. SURFACE HARDNESS OF COVER: >=6H

PINS ASSIGNMENTS FOR LCM			
NO.	SYMBOL	NO.	SYMBOL
1	VCOM	21	RXIN3+
2	VDD	22	GND
3	VDD	23	NC
4	NC	24	NC
5	RESET	25	GND
6	STBYB	26	NC
7	GND	27	DIMO
8	RXIN0-	28	SELB
9	RXIN0+	29	AVDD
10	GND	30	GND
11	RXIN1-	31	LED-
12	RXIN1+	32	LED-
13	GND	33	L/R
14	RXIN2-	34	U/D
15	RXIN2+	35	VGL
16	GND	36	CABCEN1
17	RXCLKIN-	37	CABCEN0
18	RXCLKIN+	38	VGH
19	GND	39	LED+
20	RXIN3-	40	LED+

PINS ASSIGNMENTS FOR CTP			
NO.	SYMBOL	NO.	SYMBOL
1	RST	4	INT
2	VCC	5	SDA
3	GND	6	SCL

05	ADD THE POSITION DIMENSIONS OF FPC CONNECTOR.	RITA	2021.09.15
04	ADD THE CONNECTOR MODEL OF CTP.	CAROL	2021.07.07
03	CORRECT THE SIZE OF PIXEL PITCH.	RITA	2021.01.25
02	CORRECT THE TOP POLARIZER SURFACE TREATMENT FROM ANTI-GLARE TO GLARE.	RITA	2020.06.19
01	FIRST ISSUE	RITA	2017.03.09
VER.	REVISED DESCRIPTION	REVISOR	DATE

DRAWN BY:				MODULE P/N:	
RITA 2017.03.09				MI0800RT-3CP	
CHECKED BY:				SCALE : 1/1	
				UNIT: mm	
APPROVED BY:				DESCRIPTION:	
05				TFT + CTP MODULE	
SHEET NO.: 1/1					



MULTI-INNO TECHNOLOGY CO., LTD.