

PIN DESCRIPTION FOR CON4	
PIN	SYMBOL
1	VCOM
2	VDD
3	VDD
4	NC
5	RESET
6	STBYB
7	GND
8	RXINO-
9	RXINO+
10	GND
11	RXIN1-
12	RXIN1+
13	GND
14	RXIN2-
15	RXIN2+
16	GND
17	RXCLKN-
18	RXCLKN+
19	GND
20	RXIN3-
21	RXIN3+
22	GND
23	NC
24	NC
25	GND
26	NC
27	DIMO
28	SELB
29	AVDD
30	GND
31	LEDK
32	LEDK
33	L/R
34	U/D
35	VGL
36	CABCEN1
37	CABCEN0
38	VGH
39	LEDA
40	LEDA

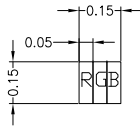

DETAIL A
(SCALE 40:1)

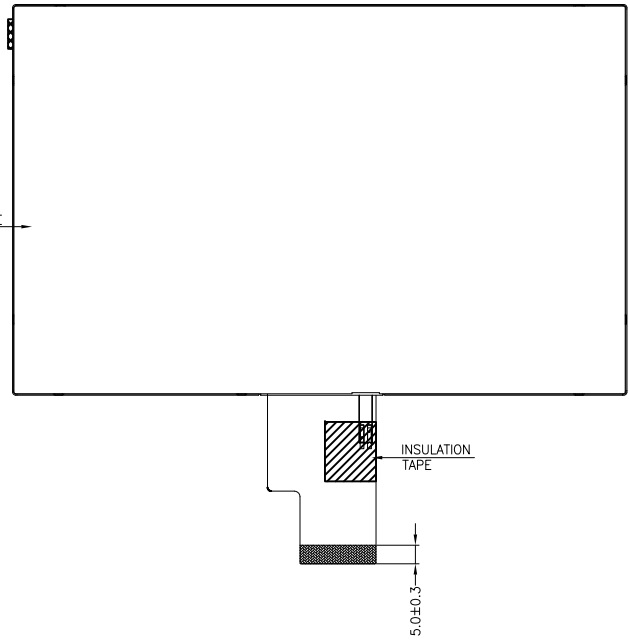
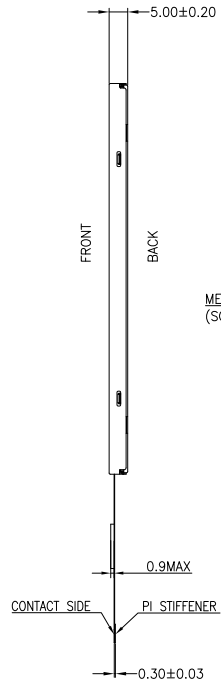
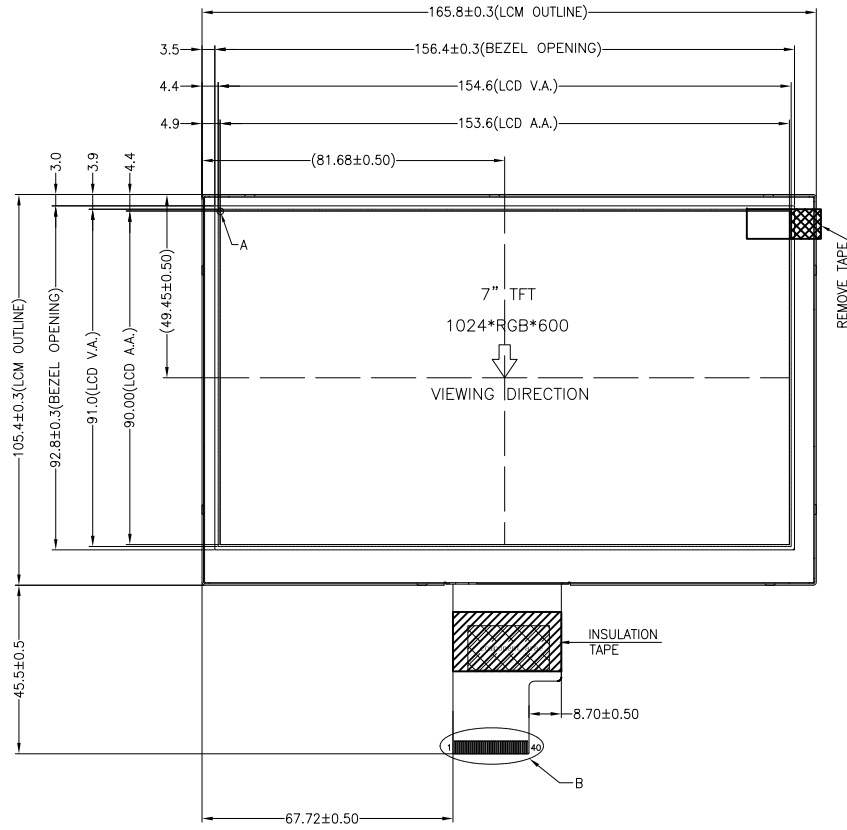
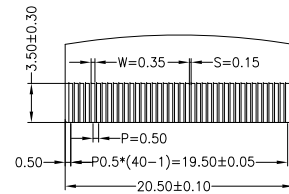

DETAIL B
(SCALE 4:1)

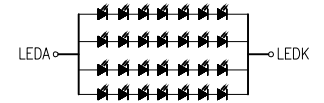

BACKLIGHT CIRCUIT DIAGRAM

NOTES:

1. DISPLAY TYPE: TFT, TRANSMISSIVE, NORMALLY WHITE
2. OPERATING VOLTAGE: VDD=3.3V (TYP.)
3. VIEWING DIRECTION: 12 O'CLOCK
4. DRIVER IC: HX8282-A+HX8677-G
5. OPERATING TEMP.: -30°C ~ 85°C
6. STORAGE TEMP.: -30°C ~ 85°C
7. LED BACKLIGHT: WHITE LED, If=230mA, Vf=18.9V~23.8V
8. ONLY THE SINGLE LAYER AREA ON FPC IS BENDABLE AND THE MINIMUM BEND RADIUS IS 1.5MM
9. SURFACE LUMINANCE: 1800CD/M² (TYP.)
10. TOP POLARIZER SURFACE TREATMENT: ANTI-GLARE
11. GENERAL TOLERANCE: ±0.30MM
12. ROHS COMPLIANT

MULTI-INNO TECHNOLOGY CO., LTD.			
DRAWN BY:	JERRY 2022.04.18		MODULE P/N:
CHECKED BY:		SCALE : 1/1	MI0700CGT-2
APPROVED BY:		UNIT: mm	DESCRIPTION:
VERSION NO:	01	SHEET NO.: 1/1	TFT MODULE

01	FIRST ISSUE	JERRY	2022.04.18
VER.	REVISED DESCRIPTION	REVISER	DATE