

16-BIT MODE(CN2)		
PIN NO.	SYMBOL	
1	GND	
2	VCC	
3	BL_E	
4	RS	
5	/WR	
6	/RD	
7	DB0	
8	DB1	
9	DB2	
10	DB3	
11	DB4	
12	DB5	
13	DB6	
14	DB7	
15	DB8	
16	DB9	
17	DB10	
18	DB11	
19	DB12	
20	DB13	
21	DB14	
22	DB15	
23	VCC	
24	GND	
25	/CS	
26	/RST	
27	TE	
28	X1	
29	Y1	
30	X2	
31	Y2	
32	DISP	

△ CN2 CONNECTOR MATED FPC/FFC STYLE (SCALE 2:1)

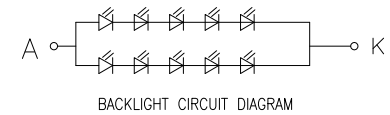

- NOTES:
1. DISPLAY TYPE: TN TFT/TRANSMISSIVE/NORMALLY WHITE.
 2. VIEWING DIRECTION: 12 O'CLOCK.
 3. OPERATING VOLTAGE: VCC=3.3V(TYP).
 4. OPERATING TEMP.: -20°C -- +70°C.
 5. STORAGE TEMP.: -30°C -- +80°C.
 6. LCD CONTROLLER: SSD1963.
 7. INTERFACE: 8/16-BIT 8080 MPU.
 8. BACKLIGHT: WHITE LED.
 9. TOP POLARIZER SURFACE TREATMENT: ANTI-GLARE. △
 10. GENERAL TOLERANCE: ±0.30mm.
 11. ROHS COMPLIANT.

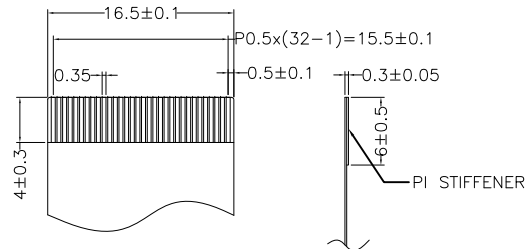
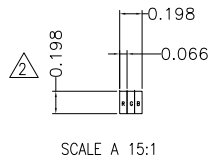

MULTI-INNO TECHNOLOGY CO.,LTD.

VER.	REVISED DESCRIPTION	REVISER	DATE
05	ADD CN2 CONNECTOR MATED FPC/FFC STYLE.	CAROL	2019.09.20
04	MODIFY THE DEFINITION OF PIN CORRECT THE ASSEMBLY TOLERANCES BETWEEN TFT AND RTP	RITA	2017.04.11
03	MODIFY SOME ASSEMBLY DIMENSIONS	RITA	2017.04.11
02	CORRECT THE P/N OF CONNECTOR	RITA	2017.01.01
01	First issue	JACK	2014.03.18

DRAWN BY:	JACK	2014.03.18	SCALE : 1/1	MODULE P/N:
CHECKED BY:			UNIT: mm	MI0430L1T-4
APPROVED BY:				DESCRIPTION:
VERSION NO:	05			TFT & RTP MODULE