

PIN FUNCTION

1	V0	14	D7
2	V4	15	D6
3	V3	16	D5
4	V2	17	D4
5	V1	18	D3
6	C2-	19	D2
7	C2+	20	D1
8	C1+	21	D0
9	C1-	22	/RD
10	C3+	23	/WR
11	VOUT	24	A0
12	VSS	25	/RES
13	VDD	26	/CS1

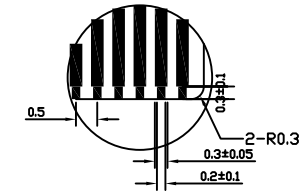
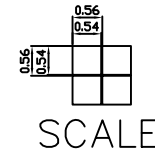
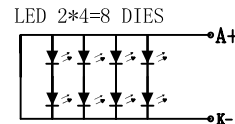
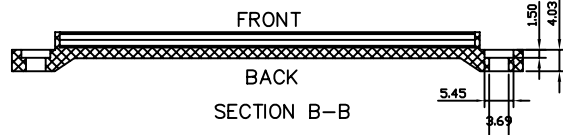

DETAIL D SCALE 8:1

NOTES:

1. DISPLAY TYPE: STN Y/G.
2. POLARIZER MODE: TRANFLECTIVE/POSITIVE.
3. VIEWING DIRECTION: 6 O'CLOCK.
2. DRIVE METHOD: 1/65DUTY, 1/9BIAS, VDD=3.3V, VOP=8.6V.
4. IC DRIVER: NT7534H-BDT.
5. OPERATING TEMP: -20°C ~ 70°C.
6. STORAGE TEMP: -30°C ~ 75°C.
7. LED BACKLIGHT: EDGE VA-VK=4.2±0.2V 40mA 8DIES,Y/G
THE B/L BRIGHTNESS: 20cd/m², UNIFORMITY 70%
8. RoHS COMPLIANT.
9. MAX. OPERATING HUMIDIYT = 95%@50°C.
10. ALL DIMENSIONS ARE IN MILLIMETERS.
11. NON-SPECIFIED TOLERANCE ±0.2.

VERSION MODIFYCONTENT

UNMARKED TOLERANCE: X: ±1 X.X: ±0.5 X.XX: ±0.1 X.XX: ±0.05 ANGLE: ±0.5°	CUSTOMER APVL		DATE	TITLE	
	DRAWN	冯伟 22/7-2008	SCALE 1:1	MODULE	
	CHECK		UNIT	MI12864G-G	
	APPROVAL			MODEL	
MULTI-INNO TECHNOLOGY CO.,LTD				DWG NO	PAGE
				00	1/5